

MEETING ROOMS

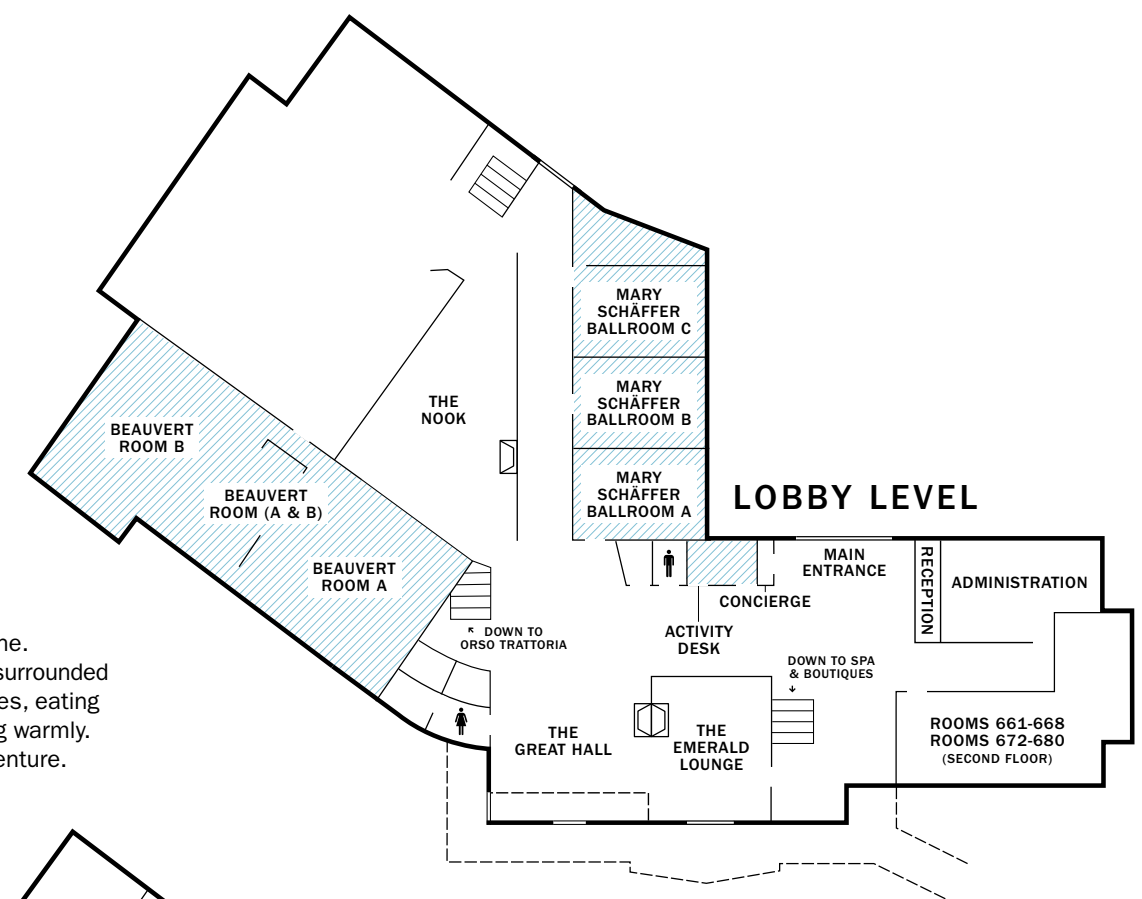

The soaring lodge roofline. The crackling fireplace, surrounded by people – playing games, eating and drinking, connecting warmly. The heart of winter adventure.



From massage therapy to retail therapy. Fitness to fine art. Fresh sushi to Italian cuisine. Plus mementos to remember it all.

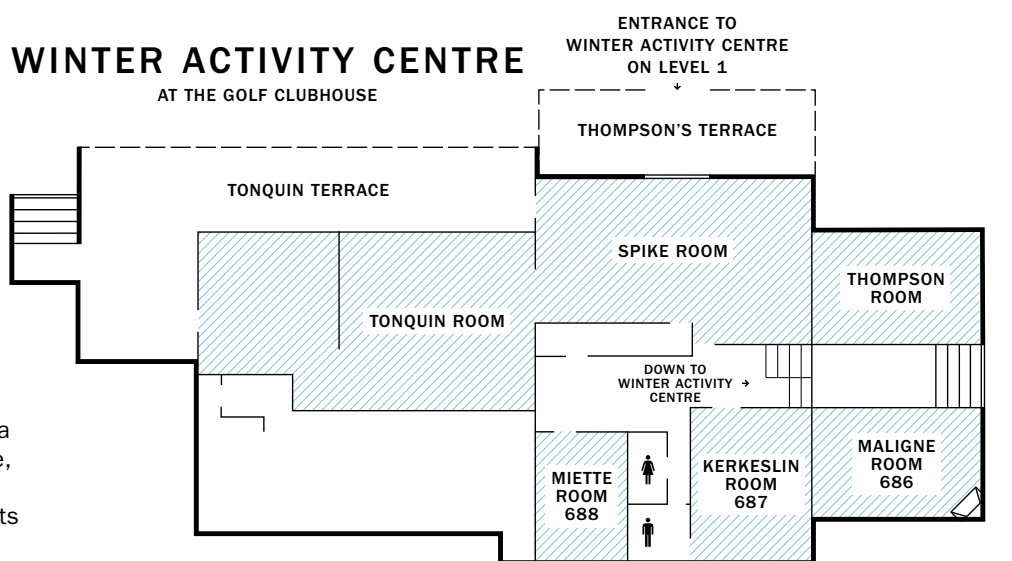

When the snow falls, winter adventure begins. On snowshoes. On bikes. On skis and sleds and skates. Get the gear here – and get yourself out there.



Scan this code for a resort activity guide, and details on all our open restaurants and amenities.

**DINING**

**THE EMERALD LOUNGE**  
An iconic lounge with a roaring fireplace, handcrafted cocktails, and infinite views to mountain peaks.

**THE GREAT HALL**  
Cozy elegance and nourishing meals all day, plus local craft brews and cocktails.

**ORSO TRATTORIA\***  
Modern alpine cuisine with Italian soul. Inspired by Northern Italy and paired with classic and modern cocktails and a curated wine list.

**THE NOOK\***  
Celebrating the finest Alberta has to offer. Classic steakhouse cuisine with a dry-aged steak program and culinary twists. Open Seasonally.

**FITZHUGH'S FINE FOODS**  
A wilderness corner store for takeaway coffee, alpine picnics, beer, wine and champagne by the bottle, gourmet snacks and sandwiches.

**OKA SUSHI\***  
Japanese tradition on the Shops & Spa Level.

**IN-ROOM DINING**  
Cozy up in your cabin with breakfast in bed or a relaxing dinner delivered directly from our chefs to you.

\*Reservations recommended. To book a table, please contact the concierge or visit Open Table. 780.852.6091 | jpl.concierge@fairmont.com

**SPA, SERVICES & SHOPS**

**HEALTH CLUB & SWIMMING POOL**  
Magical 4-season heated pool, with mythic views of the lakeshore and mountains, plus fitness centre.

**FAIRMONT SPA**  
Voted #1 Spa in Alberta. To book a treatment or for more information, please contact: 780.852.6014 | jpl.spa@fairmont.com

**MOUNTAIN GALLERIES**  
A vivid collection of contemporary Canadian art, inspired by our wilderness.

**WILD ORCHID SALON**  
Salon services for adults and kids, including bridal, lashes, and nails. Bookings at wildorchidjasper.com.

**FAIRMONT STORE**  
Luxury gifts, jewelry, high-end fashion, Fairmont bedding, and more.

**CAMP JPL ADVENTURE CLUB**  
A wilderness adventure camp for kids ages 5 - 12 – where day-long fun becomes lifelong memories.

**WINTER ACTIVITY CENTRE AT THE GOLF CLUBHOUSE**  
Suit up with skates, skis, snowshoes, toboggans, and fat-tire bikes.

**THE BEAR'S DEN - GOLF SIMULATOR**  
Located in the Maligne Room at the Golf Clubhouse. Open year round

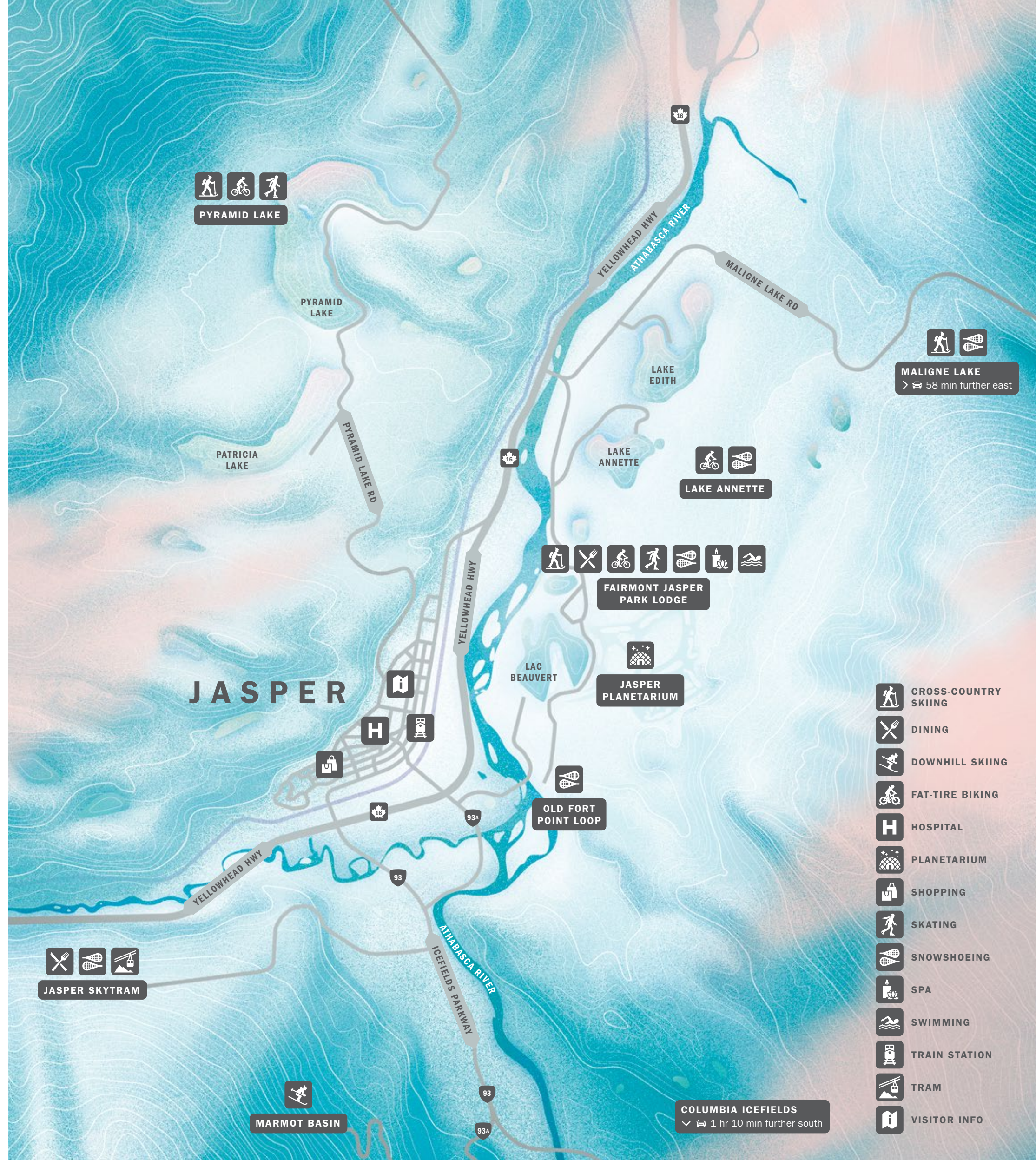

# Fairmont

JASPER PARK LODGE

## THE HEARTH IS ROARING. THE MOUNTAINS AWAIT.

Welcome to the heart of winter adventure. The crackling fire. The clear cold air. The unforgettable lodge setting, nestled in the immortal Rocky Mountains. Here, you'll skate on frozen glacial lakes and stand on windswept peaks, surrounded by living nature and the glittering stars of one of the world's largest dark sky preserves. When you return, we'll embrace you with a luxury service that has played host to 100 years of Canadian mountain journeys.

CANADA'S ULTIMATE CABIN ESCAPE - WILDLY UNFORGETTABLE



- 1 **MAIN LODGE**  
Check in, and plan your adventure. When the day is done, refresh your soul with a spa day or a swim – followed by an impeccable meal.
  - 2 **HEALTH CLUB, SPA & SWIMMING POOL**  
Fitness centre, sauna, hot tub and outdoor heated pool.
  - 3 **WINTER ACTIVITY CENTRE AT THE GOLF CLUBHOUSE**  
Sharpen your skates for loops around the lake. Rent skis for cross-country days, and alpine afternoons. Find fat-tire bikes, snowshoes, toboggans, and winter gear. All in one place.
  - 4 **TOBOGGAN PARK**  
It's all downhill from here – with the most classic winter activity there is.
  - 5 **MILDRED LAKE ICE PARK**  
The wonderland begins at Mildred Lake, with a cross-country ski track, 1km skating oval, and a hockey rink – all in view of the ancient mountains all around us.
  - 6 **WARMING HUT**  
Gather here to lace up your skates, warm yourself around the fire, or just take a break from endless laps around the frozen lake.
  - 7 **PLANETARIUM**  
Glittering stars and planets in the world's largest dark sky preserve. Please book through Concierge.
  - 8 **SUN DECKS**  
Places to pause, breathe, and soak up the landscape.
  - 9 **PLAYGROUND**  
A space for kids to play, run, and dream.
  - 10 **BEAUVERT PLATEAU**
  - 11 **WHISTLER PLATEAU**
  - 12 **LAKEFRONT RIDGE**  
Beauvert Plateau, Whistler Plateau and Lakefront Ridge are ideal for outdoor events, wedding ceremonies and receptions, in full view of Lac Beauvert.
  - 13 **CROSS-COUNTRY SKI TRAIL**  
The shush of skis. The silence of the woods. The ancient art of Nordic skiing finds its perfect home here.
  - 14 **WOODPECKER TRAIL TO LAKE ANNETTE**  
Snowshoeing and fat-tire biking; two ways to immerse yourself in winter, and forge a deep connection to the land.
- WALKING TRAIL**
- TRAIL TEMPORARILY CLOSED**
- PHOTO OPPORTUNITIES**
- WIFI:** Enter code 'JPL' into WiFi login screen. (Room number & last name not required)
- Please note that all outdoor activities are weather dependent and hours are subject to change. For the most up-to-date information, please connect with our Royal Service Team. Call 780.852.3301, text 587.788.3333 or dial 55 from your Guest Room.